

ORDINANCE NO. \_\_\_\_\_

1 AN ORDINANCE REZONING AND CHANGING THE ZONING MAP FOR THE  
2 PROPERTY LOCATED AT 703 1/2, 801, 805, AND 821 WOODWARD STREET IN  
3 THE GREATER SOUTH RIVER CITY COMBINED NEIGHBORHOOD PLAN  
4 AREA FROM COMMUNITY COMMERCIAL-VERTICAL MIXED USE  
5 BUILDING-CONDITIONAL OVERLAY-NEIGHBORHOOD PLAN (GR-V-CO-  
6 NP) COMBINING DISTRICT TO COMMUNITY COMMERCIAL-VERTICAL  
7 MIXED USE BUILDING-CONDITIONAL OVERLAY-DENSITY BONUS 90-  
8 NEIGHBORHOOD PLAN (GR-V-CO-DB90-NP) COMBINING DISTRICT.

9  
10 BE IT ORDAINED BY THE CITY COUNCIL OF THE CITY OF AUSTIN:

11  
12 **PART 1.** The zoning map established by Section 25-2-191 of the City Code is amended to  
13 change the base district from community commercial-vertical mixed use building-  
14 conditional overlay-neighborhood plan (GR-V-CO-NP) combining district to community  
15 commercial-vertical mixed use building-conditional overlay-density bonus 90-  
16 neighborhood plan (GR-V-CO-DB90-NP) combining district on the property described in  
17 Zoning Case No. C14-2024-0052, on file at the Planning Department, as follows:

18  
19 LOT A, S.A.C. ADDITION, a subdivision in the City of Austin, Travis County,  
20 Texas, according to the map or plat of record in Volume 69, Page 88, of the Plat  
21 Records of Travis County, Texas; and

22  
23 LOT 2, BLOCK A, RESUBDIVISION OF A PORTION OF TRACT 2, PENICK  
24 SUBDIVISION, a subdivision in the City of Austin, Travis County, Texas,  
25 according to the map or plat of record in Volume 101, Page 41, of the Plat Records  
26 of Travis County, Texas,

27  
28 (collectively, the "Property"),

29  
30 locally known as 703 1/2, 801, 805, and 821 Woodward Street in the City of Austin, Travis  
31 County, Texas, generally identified in the map attached as **Exhibit "A"**.

32  
33 **PART 2.** The Property within the boundaries of the conditional overlay combining district  
34 established by this ordinance is subject to the following conditions:

- 35  
36 (A) A 100-foot building setback shall be provided and maintained along the west  
37 property line adjacent to and intersecting with Blunn Creek. The 100-foot  
38 building setback area is measured parallel from the centerline of Blunn Creek.  
39

40 (B) The following uses are prohibited uses of the Property:  
41

Alternative Financial Services	Automotive Rentals
Automotive Repair Services	Automotive Sales
Automotive Washing (of any type)	Exterminating Services
Funeral Services	Pawn Shop Services
Pedicab Storage and Dispatch	Service Station

42  
43 **PART 3.** When a site abuts a principal street, 75 percent of the building frontage must be  
44 designed for one or more commercial or civic uses and must comply with the dimensional  
45 requirements found in Section 4.3.3.C in Subchapter E (*Design Standards and Mixed*  
46 *Use*).

47  
48 **PART 4.** Except as specifically restricted under this ordinance, the Property may be  
49 developed and used in accordance with the regulations established for the community  
50 commercial (GR) base district and other applicable requirements of the City Code.

51  
52 **PART 5.** Except as specifically modified by this ordinance, the Property is subject to  
53 Ordinance No. 20050929-Z002 that established zoning for the St. Edward's Neighborhood  
54 Plan.

55  
56 **PART 6.** This ordinance takes effect on \_\_\_\_\_, 2024.

57  
58 **PASSED AND APPROVED**

59  
60 \_\_\_\_\_ §  
61 \_\_\_\_\_ §  
62 \_\_\_\_\_, 2024 § \_\_\_\_\_

63 Kirk Watson  
64 Mayor

65  
66  
67 **APPROVED:** \_\_\_\_\_ **ATTEST:** \_\_\_\_\_  
68 Anne L. Morgan Myrna Rios  
69 City Attorney City Clerk  
70

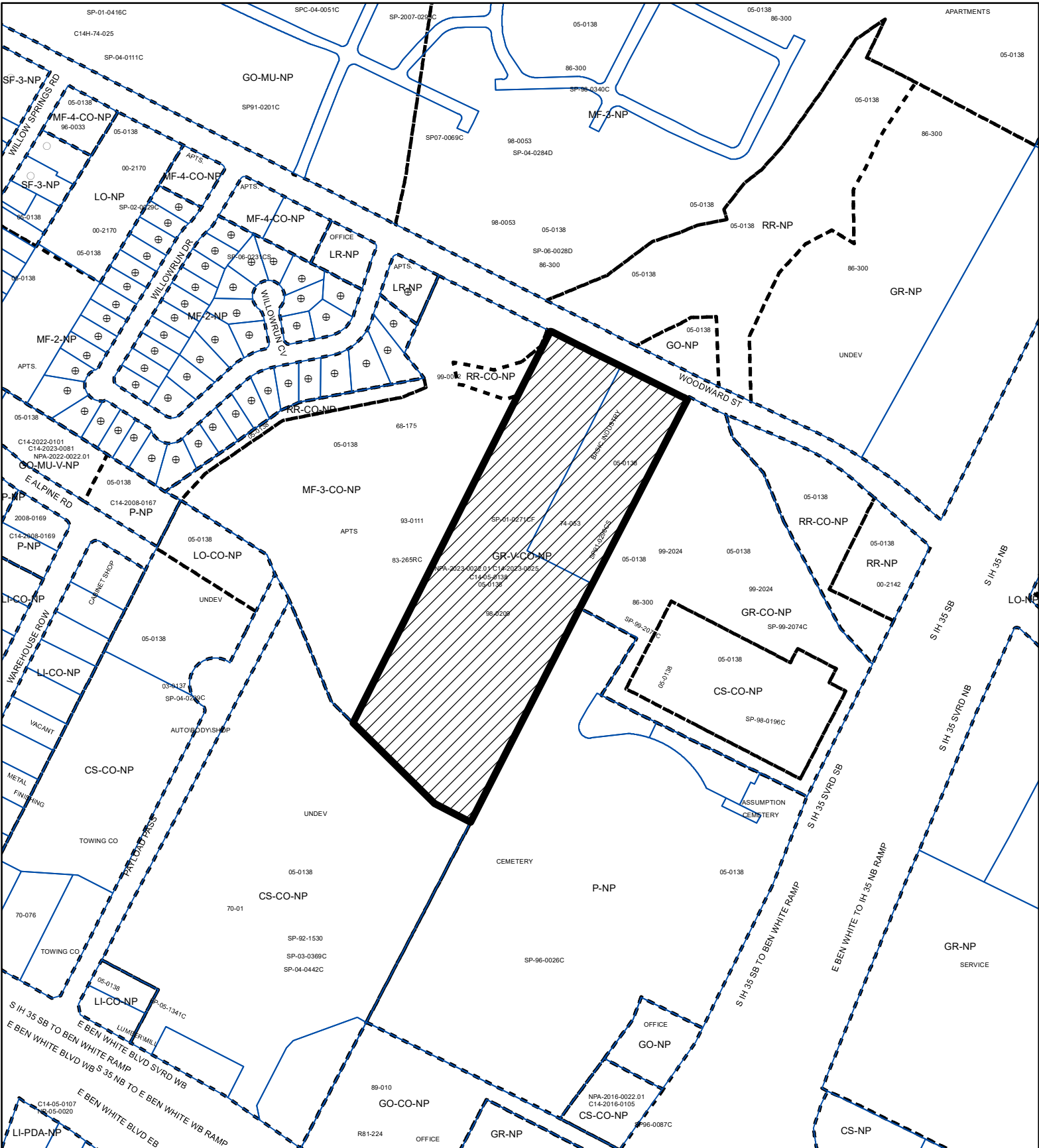



**ZONING**

**EXHIBIT "A"**

ZONING CASE#: C14-2024-0052



-  SUBJECT TRACT
-  PENDING CASE
-  ZONING BOUNDARY

1" = 400'

This product is for informational purposes and may not have been prepared for or be suitable for legal, engineering, or surveying purposes. It does not represent an on-the-ground survey and represents only the approximate relative location of property boundaries.

This product has been produced by the Planning Department for the sole purpose of geographic reference. No warranty is made by the City of Austin regarding specific accuracy or completeness.



Created: 4/8/2024