

**ORDINANCE NO. \_\_\_\_\_**

**AN ORDINANCE AMENDING ORDINANCE NO. 20050818-Z001, WHICH ADOPTED THE SOUTH CONGRESS COMBINED NEIGHBORHOOD PLAN AS AN ELEMENT OF THE IMAGINE AUSTIN COMPREHENSIVE PLAN, TO CHANGE THE LAND USE DESIGNATION ON THE FUTURE LAND USE MAP FOR PROPERTY LOCATED AT 6201 CROW LANE.**

**BE IT ORDAINED BY THE CITY COUNCIL OF THE CITY OF AUSTIN:**

**PART 1.** Ordinance No. 20050818-Z001 adopted the South Congress Combined Neighborhood Plan as an element of the Imagine Austin Comprehensive Plan.

**PART 2.** Ordinance No. 20050818-Z001 is amended to change the land use designation for the property located at 6201 Crow Lane from Mixed Use/Office to Neighborhood Mixed Use on the future land use map attached as **Exhibit "A"** and incorporated in this ordinance and described in File NPA-2024-0020.01 at the Planning Department.

**PART 3.** This ordinance takes effect on \_\_\_\_\_, 2025.

**PASSED AND APPROVED**

§  
§  
§

\_\_\_\_\_  
Kirk Watson  
Mayor

**APPROVED:** \_\_\_\_\_  
Deborah Thomas  
City Attorney

**ATTEST:** \_\_\_\_\_  
Erika Brady  
City Clerk

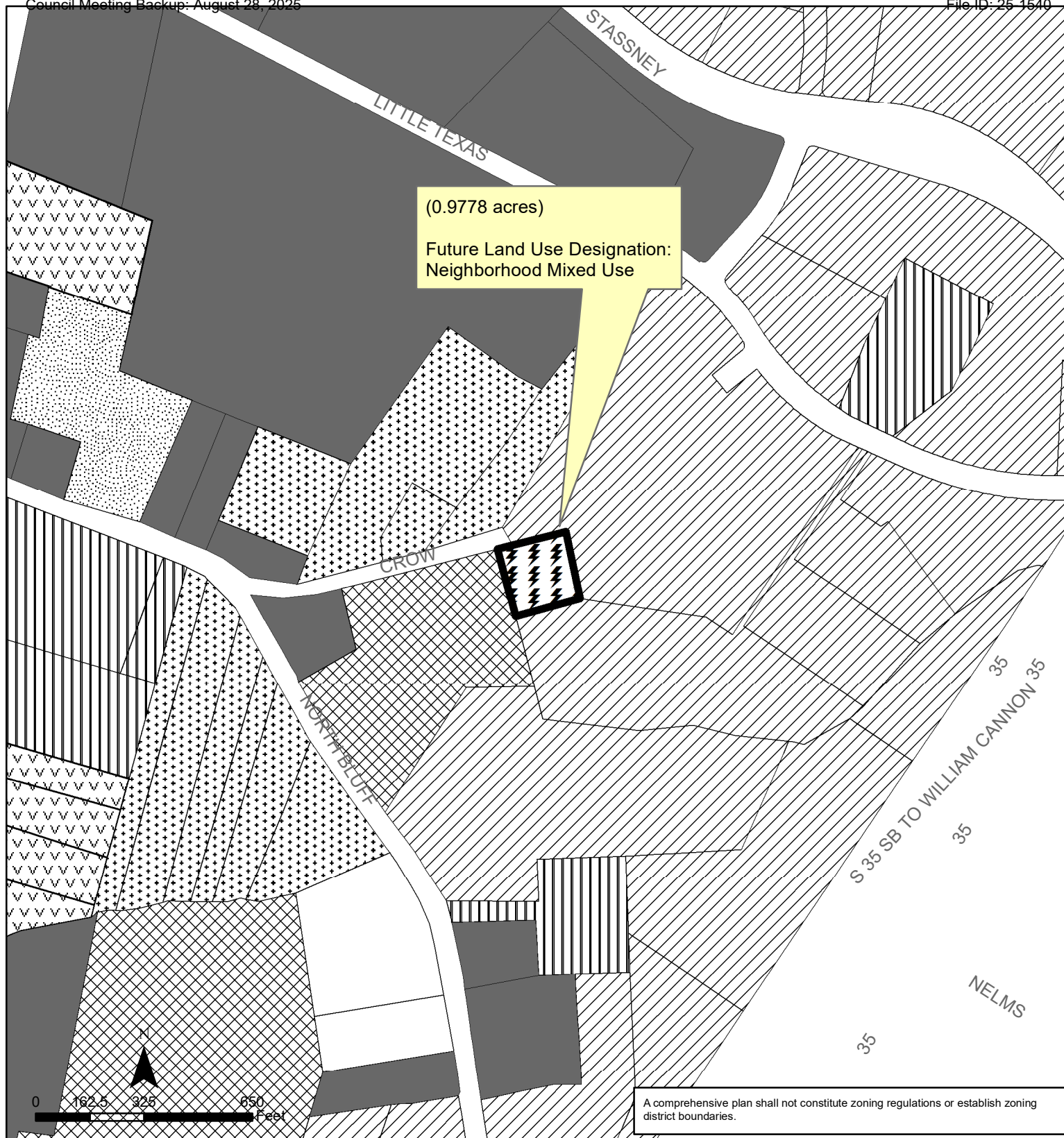

## Exhibit A

### South Congress Combined Neighborhood Planning Area

#### NPA-2024-0020.01

This product is for informational purposes and may not have been prepared for or be suitable for legal, engineering, or surveying purposes. It does not represent an on-the-ground survey and represents only the approximate relative location of property boundaries.

This product has been produced by the Planning Department for the sole purpose of geographic reference. No warranty is made by the City of Austin regarding specific accuracy or completeness.



City of Austin  
Planning Department  
Created on 6/26/2025, by: MeeksS

### Future Land Use

	Subject Tract		Mixed Use
	Civic		Mixed Use/Office
	Commercial		Mobile Homes
	Higher-Density Single-Family		Multi-Family
	Mixed Residential		Single-Family