







MEMORANDUM

TO: Mayor and City Council

THROUGH: Jon Fortune, Deputy City Manager 

FROM: Richard Mendoza, P.E., Director, Transportation and Public Works 
Jesús Aguirre, Director, Parks and Recreation 
Jorge L. Morales, P.E., CFM, Director, Watershed Protection 

DATE: August 1, 2025

SUBJECT: **I-35 Construction Impacts on Hike and Bike Trail, Parking and Water Quality**

The purpose of this memorandum is to provide information related to Texas Department of Transportation's (TxDOT) Capital Express Central project that will involve reconstructing Interstate 35 over Lady Bird Lake. This project is led and managed by TxDOT, and it will impact the Ann and Roy Butler Hike-and-Bike Trail and Boardwalk at Lady Bird Lake, as well as several other City-owned assets, including Edward Rendon Sr. Park at Festival Beach, Waller Beach at Town Lake Metro Park, Chicano Park, and Norwood Dog Park.

Trail impacts from the work on the [Lady Bird Lake Segment \(Holly Street to SH 71/Ben White Boulevard\)](#) will begin Aug. 10, 2025. TxDOT has informed the City of Austin this work will restrict access to the parking lot along East Avenue under the interstate. Parking areas currently available beneath I-35 in the project corridor will be closed for the duration of this construction phase. The City will coordinate with TxDOT to help notify the public of parking changes and, where possible, identify alternative options.

The project will also require temporary long-term closures and detours of the Ann and Roy Butler Hike-and-Bike Trail in this area. TxDOT will create ADA-accessible detours that will be used as construction activity begins in the area in late 2025.

According to TxDOT's [July 7, 2025, newsletter update](#), anticipated near-term travel impacts include:

- Southbound I-35 Woodland Avenue exit will be closed through early 2026. Drivers on southbound I-35 will use the Riverside Drive exit.
- Northbound I-35 Cesar Chavez entrance ramp will be closed through early 2026. Drivers on northbound I-35 frontage road will use the entrance ramp between Eighth Street and 11th streets.
- Access will be limited under the Lady Bird Lake bridge along the north shore for the month of August 2025, so crews can store equipment and materials. Pedestrians and bicyclists may continue their path around the staged equipment. This closure of the under-bridge area will be

PAGE: 2 of 7
DATE: August 1, 2025
SUBJECT: I-35 Construction Impacts on Hike and Bike Trail, Parking and Water Quality

effective on Sunday, Aug. 10, 2025., and run through Sunday, Aug. 31, 2025. A map of the impacted area is attached.

Per TxDOT's [Final Environmental Impact Statement \(FEIS\)](#), portions of the trail will be closed and people biking and walking will be detoured away from the lake's shores. The lake and trail will experience periodic closures for three to seven days at a time up to three times per year throughout the duration of construction, which is anticipated to be complete in 2033 (FEIS Page 402).

As outlined in the project's [environmental documentation](#), TxDOT retains the right to temporarily close all waterway access along Lady Bird Lake within the bridge construction zone. These closures may include restricting boating, paddling, and other activities beneath the bridge to ensure public safety during demolition and construction activities. Public notifications and signage will be provided by TxDOT and/or its contractor in advance of any closures, and TxDOT will coordinate with the City to support waterway users and local businesses.

Commitments from TxDOT include:

- Best Management Practices for erosion and sediment control
- Containment systems to prevent construction runoff from entering Lady Bird Lake
- Regular inspections and monitoring of water quality throughout the construction period
- Rapid response protocols for any spills or water quality incidents

City staff will continue working closely with TxDOT project managers and community stakeholders to support clear communication and proactive problem-solving as the bridge construction progresses. Updates will be provided to Council on major milestones, trail detour plans, and waterway closure timelines.

The TxDOT contact for public inquiries about this project is Mical Roy, who is available at mroy-c@txdot.gov or (832) 728-0184. If you have any questions or would like a detailed briefing, please contact Richard Mendoza, Director, Transportation and Public Works, at RichardV.Mendoza@austintexas.gov or (512) 974-2488.

cc: T.C. Broadnax, City Manager
Erika Brady, City Clerk
Corrie Stokes, City Auditor
Judge Sherry Statman, Presiding Judge
Mary Jane Grubb, Municipal Court Clerk
CMO Executive Team

Attachments: (1) Map of impact area
(2) Tree removal map
(3) Parkland mitigation invoice

Attachment 1
Map of impact area



Attachment 2
Tree removal map

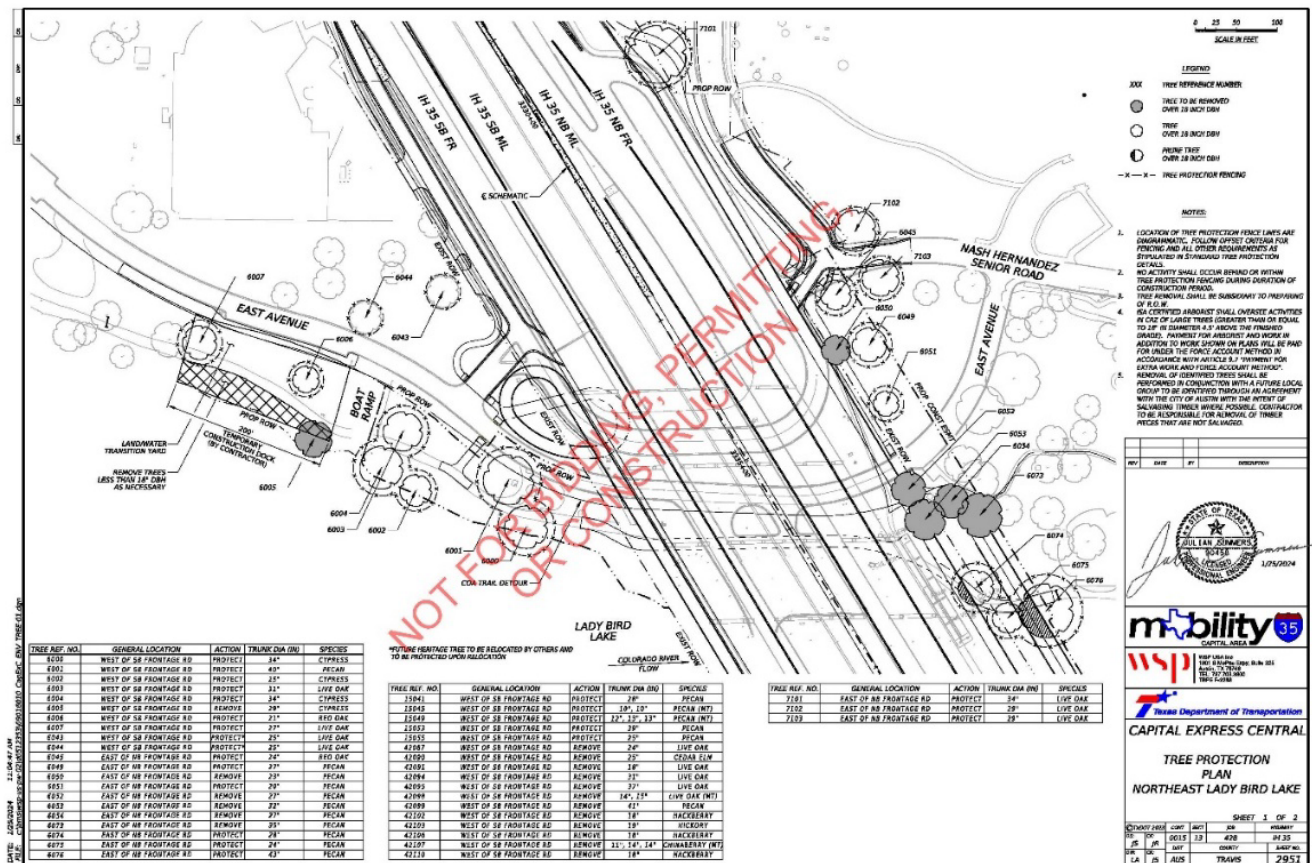

Attachment 2 Cont'd
Tree removal map

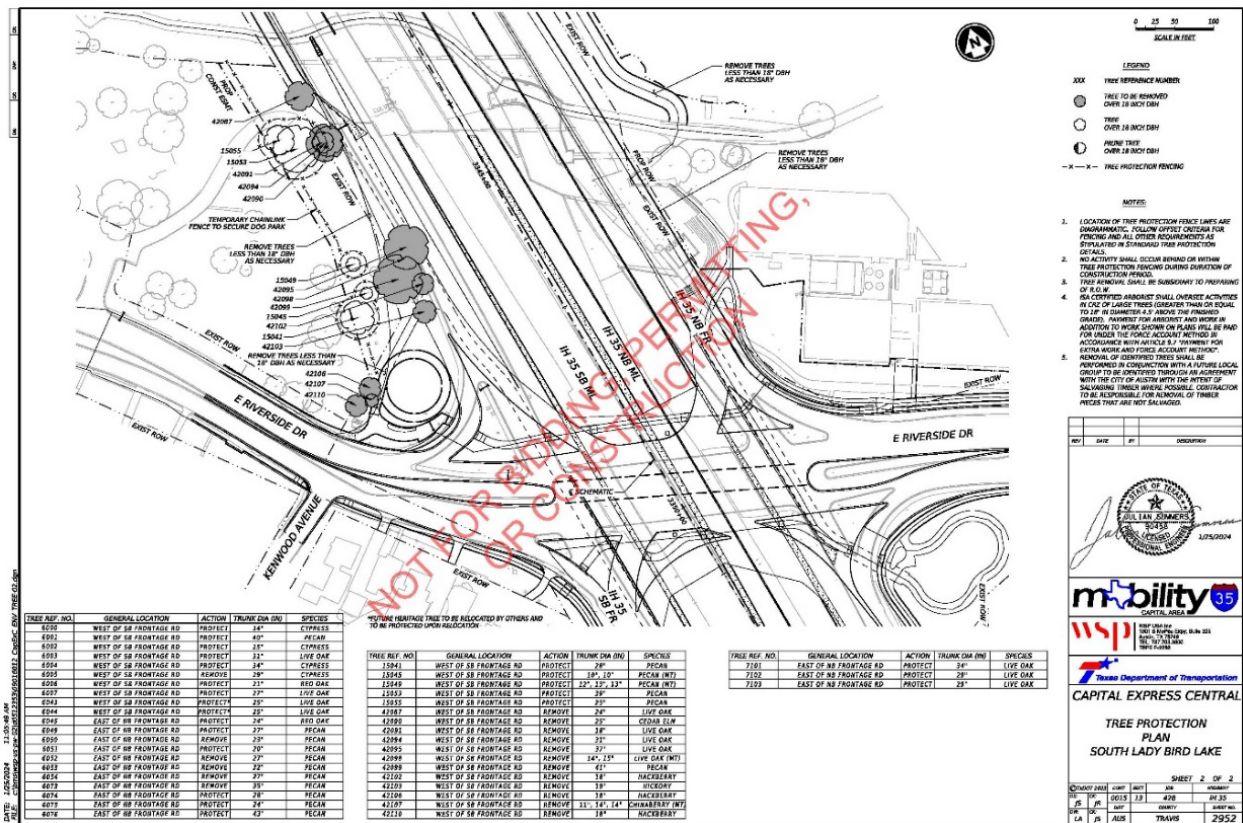

Attachment 3
Parkland mitigation invoice



City of Austin

Parks and Recreation Department
200 South Lamar Blvd., Austin, Texas 78704-1099

June 20, 2024

Scott Ford, Environmental Supervisor- Austin District
7901 North IH 35
Austin, Texas 78753

Scott:

PARD understands that three (3) trees must be removed due to the temporary use of parkland to support the operations needed for the expansion of the IH-35 Central Expressway project. Following the tree preservation requirements of the City of Austin's Environmental Criteria Manual, the removal of these three (3) trees at Edward Rendon Sr. Park at Festival Beach would require either the planting of 209 caliper inches of new trees including irrigation for three (3) years for establishment, or payment in lieu of planting as mitigation.

According to the City's Environmental Criteria manual, mitigation for the three trees is calculated at the rates below:

(ECM 3.5.4 A.)

- 6050: 23" pecan (Protected) x 100% = 23"
- 6054: 27" pecan (Heritage) x 300% = 81"
- 6073: 35" pecan (Heritage) x 300% = 105"

Total: 209 cal. inches to be mitigated or \$41,800 @ \$200 cal. inch
(ECM 3.5.4 B.3b)

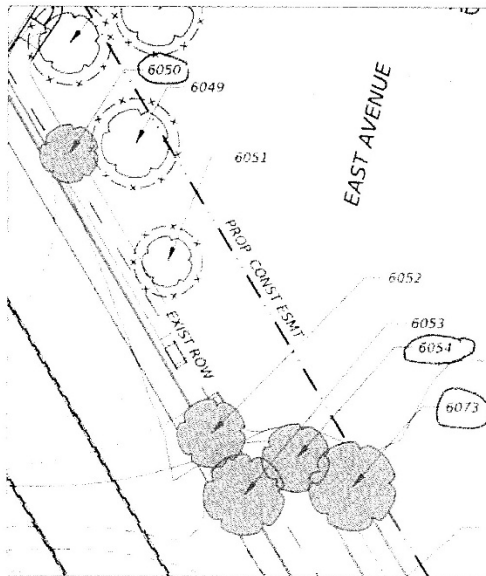

PAGE: 7 of 7
DATE: August 1, 2025
SUBJECT: I-35 Construction Impacts on Hike and Bike Trail, Parking and Water Quality

Total Parkland Mitigation Amount = \$41,800

Texas Department of Transportation (IH-35 Central Expressway Expansion Project) agrees to provide the above mitigation in return for the removal of 209 caliper inches of protected and Heritage sized trees on parkland. You can send payment to the department's address attention: Ricardo Soliz.

Sincerely,

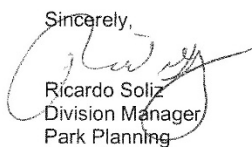

Ricardo Soliz
Division Manager
Park Planning

*The City of Austin is committed with the Americans with Disabilities Act.
Reasonable modifications and equal access to communications will be provided upon request.*