

ORDINANCE NO. \_\_\_\_\_

**AN ORDINANCE REZONING AND CHANGING THE ZONING MAP FOR THE PROPERTY LOCATED AT 1900 BURTON DRIVE IN THE EAST RIVERSIDE/OLTORF COMBINED NEIGHBORHOOD PLAN AREA FROM MULTIFAMILY RESIDENCE MODERATE-HIGH DENSITY-CONDITIONAL OVERLAY (MF-4-CO) COMBINING DISTRICT TO COMMUNITY COMMERCIAL-VERTICAL MIXED USE BUILDING-CONDITIONAL OVERLAY (GR-V-CO) COMBINING DISTRICT.**

**BE IT ORDAINED BY THE CITY COUNCIL OF THE CITY OF AUSTIN:**

**PART 1.** The zoning map established by Section 25-2-191 of the City Code is amended to change the base district from multifamily residence moderate-high density-conditional overlay (MF-4-CO) combining district to community commercial-vertical mixed use building-conditional overlay (GR-V-CO) combining district on the property described in Zoning Case No. C14-2023-0123, on file at the Planning Department, as follows:

LOT 6, SECTION SIX COLORADO HILLS ESTATES, a subdivision in Travis County, Texas, according to the map or plat thereof as recorded in Volume 56, Page 100 of the Plat Records of Travis County, Texas (the "Property"),

locally known as 1900 Burton Drive in the City of Austin, Travis County, Texas, generally identified in the map attached as **Exhibit "A"**.

**PART 2.** The Property within the boundaries of the conditional overlay combining district established by this ordinance is subject to the following conditions:

(A) The following uses are prohibited uses on the Property:

Alternative financial services	Automotive rentals
Automotive repair services	Automotive sales
Automotive washing (of any type)	Bail bond services
Commercial off-street parking	Drop off recycling collection facility
Exterminating services	Funeral services
Hotel/motel	Off-site accessory parking
Outdoor entertainment	Outdoor sports and recreation
Pawn shop services	Pedicab storage and dispatch
Service station	

**PART 3.** Except as specifically restricted under this ordinance, the Property may be developed and used in accordance with the regulations established for the community commercial (GR) base district and other applicable requirements of the City Code.

**PART 4.** Except as specifically modified by this ordinance, the Property is subject to Ordinance No. 20061116-057 that established zoning for the Riverside Neighborhood Plan.

**PART 5.** This ordinance takes effect on \_\_\_\_\_, 2024.

**PASSED AND APPROVED**

SSS



Kirk Watson  
Mayor

**APPROVED:** \_\_\_\_\_ **ATTEST:** \_\_\_\_\_

Anne L. Morgan  
City Attorney

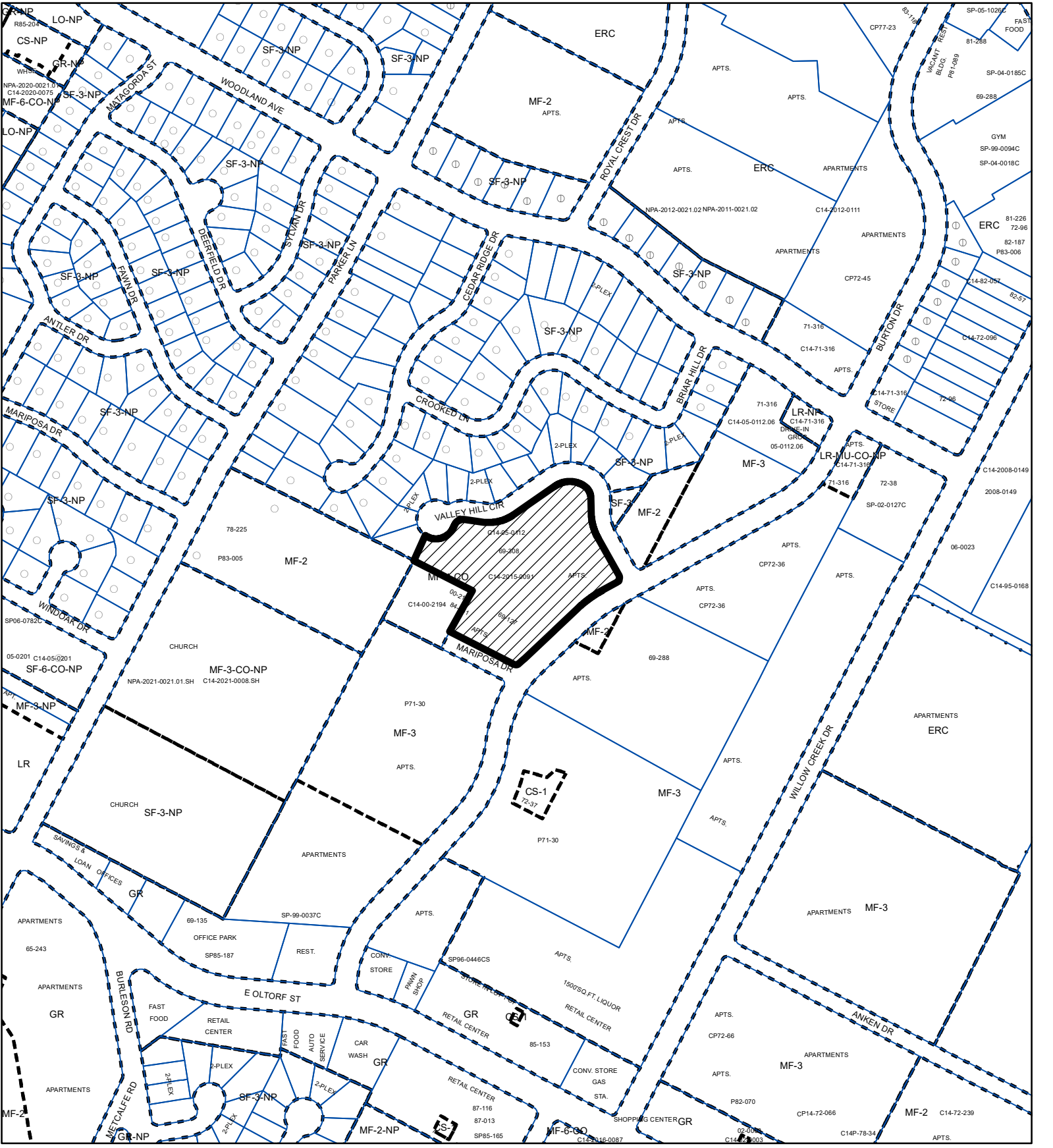
Myrna Rios  
City Clerk



-  SUBJECT TRACT
-  PENDING CASE
-  ZONING BOUNDARY

1" = 400'

**ZONING**  
**ZONING CASE#: C14-2023-0123**  
**EXHIBIT A**

This product is for informational purposes and may not have been prepared for or be suitable for legal, engineering, or surveying purposes. It does not represent an on-the-ground survey and represents only the approximate relative location of property boundaries.

This product has been produced by the Planning Department for the sole purpose of geographic reference. No warranty is made by the City of Austin regarding specific accuracy or completeness.



**Created: 10/18/2023**