

ORDINANCE NO. \_\_\_\_\_

AN ORDINANCE AMENDING ORDINANCE NO. 20090312-027 TO AMEND THE MARTIN LUTHER KING, JR. BOULEVARD (MLK) TRANSIT ORIENTED DEVELOPMENT DISTRICT (TOD) STATION AREA PLAN, AN ELEMENT OF THE IMAGINE AUSTIN COMPREHENSIVE PLAN TO CHANGE THE BOUNDARY OF THE MLK TOD STATION AREA PLAN, AND AMENDING ORDINANCE NO. 011129-67, WHICH ADOPTED THE ROSEWOOD NEIGHBORHOOD PLAN AS AN ELEMENT OF THE IMAGINE AUSTIN COMPREHENSIVE PLAN, TO CHANGE THE LAND USE DESIGNATION ON THE FUTURE LAND USE MAP FOR THE PROPERTY LOCATED AT 2967 MANOR ROAD.

BE IT ORDAINED BY THE CITY COUNCIL OF THE CITY OF AUSTIN:

**PART 1.** Exhibit “D” of Ordinance No. 20090312-027 (*MLK Boulevard TOD Station Area Plan*) is amended to change the Land Use and Design Concept Plan to remove the property located at 2967 Manor Road from the TOD District Boundary as shown on **Exhibit “A”** incorporated in this ordinance and described in File NPA-2024-0008.02 at the Planning Department.

**PART 2.** Ordinance No. 011129-67 is amended to change the land use designation for the property located at 2967 Manor Road from Specific Regulating District to Mixed Use on the future land use map attached as shown on **Exhibit “B”** incorporated in this ordinance and described in File NPA-2024-0008.02 at the Planning Department.

**PART 3.** This ordinance takes effect on \_\_\_\_\_, 2025.

**PASSED AND APPROVED**

\_\_\_\_\_, 2025      § \_\_\_\_\_  
§ \_\_\_\_\_  
§ \_\_\_\_\_

Kirk Watson  
Mayor

**APPROVED:** \_\_\_\_\_ **ATTEST:** \_\_\_\_\_  
Deborah Thomas      Myrna Rios  
Interim City Attorney      City Clerk



## Exhibit A

### Rosewood Neighborhood Planning Area

#### NPA-2024-0008.02

This product is for informational purposes and may not have been prepared for or be suitable for legal, engineering, or surveying purposes. It does not represent an on-the-ground survey and represents only the approximate relative location of property boundaries.

This product has been produced by the Planning Department for the sole purpose of geographic reference. No warranty is made by the City of Austin regarding specific accuracy or completeness.



City of Austin  
Planning Department  
Created on 7/17/2024, by: meekss

#### Future Land Use

Subject Tract	Multi-Family
Civic	Recreation & Open Space
Commercial	Single-Family
Mixed Use	Specific Regulating District
Mixed Use/Office	Transportation

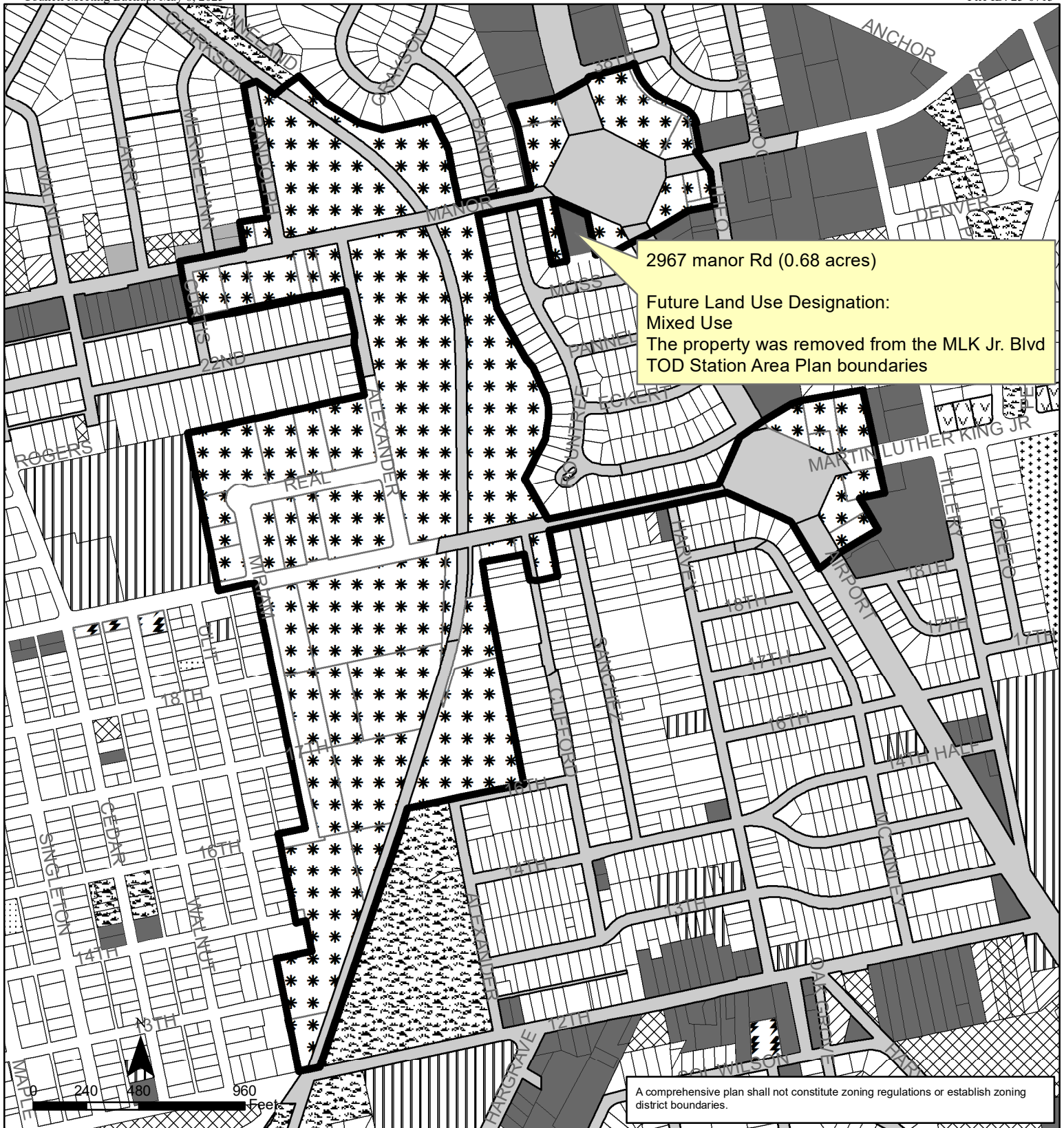

## Exhibit B

### Rosewood Neighborhood Planning Area and MLK Jr Blvd TOD Station Area Plan NPA-2024-0008.02

This product is for informational purposes and may not have been prepared for or be suitable for legal, engineering, or surveying purposes. It does not represent an on-the-ground survey and represents only the approximate relative location of property boundaries.

This product has been produced by the Planning Department for the sole purpose of geographic reference. No warranty is made by the City of Austin regarding specific accuracy or completeness.



City of Austin  
Planning Department  
Created on 3/12/2025, by: meekss

#### Future Land Use

	<Null>		Multi-Family
	Subject Tract		Neighborhood Mixed Use
	Civic		Office
	Commercial		Recreation & Open Space
	Higher-Density Single-Family		Single-Family
	Mixed Residential		Specific Regulating District
	Mixed Use		Transportation
	Mixed Use/Office		