

ORDINANCE NO. _____

AN ORDINANCE AMENDING ORDINANCE NO. 021010-11, WHICH ADOPTED THE SOUTHEAST COMBINED NEIGHBORHOOD PLAN AS AN ELEMENT OF THE IMAGINE AUSTIN COMPREHENSIVE PLAN, TO CHANGE THE LAND USE DESIGNATION ON THE FUTURE LAND USE MAP FOR PROPERTY LOCATED AT 5900 RAPID CREEK TRAIL AND 5902 THROUGH 5925 RAPID CREEK TRAIL.

BE IT ORDAINED BY THE CITY COUNCIL OF THE CITY OF AUSTIN:

PART 1. Ordinance No. 021010-11 adopted the Southeast Combined Neighborhood Plan as an element of the Imagine Austin Comprehensive Plan.

PART 2. Ordinance No. 021010-11 is amended to change the land use designation from Single Family and Recreation & Open Space to Mixed Use for the property located at 5900 Rapid Creek Trail and 5902 through 5925 Rapid Creek Trail on the future land use map attached as **Exhibit "A"** and incorporated in this ordinance and described in File NPA-2023-0014.01.SH at the Planning Department.

PART 3. This ordinance takes effect on _____, 2023.

PASSED AND APPROVED

§
§
§

_____, 2023

Kirk Watson
Mayor

APPROVED: _____ **ATTEST:** _____
Anne L. Morgan Myrna Rios
City Attorney City Clerk

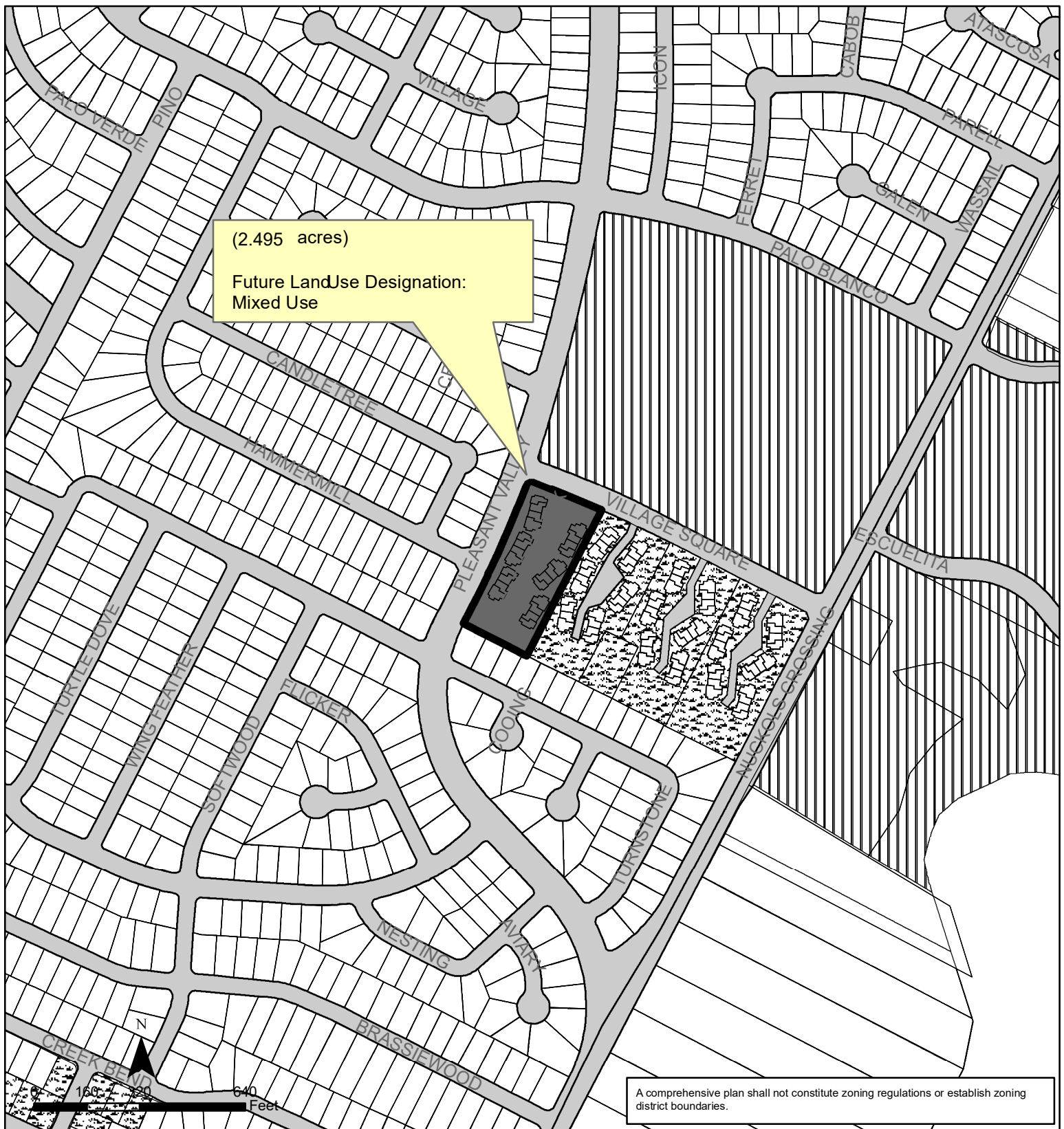

Exhibit A

Southeast Combined (Franklin Park) Neighborhood Planning Area

NPA-2023-0014.01.SH

This product is for informational purposes and may not have been prepared for or be suitable for legal, engineering, or surveying purposes. It does not represent an on-the-ground survey and represents only the approximate relative location of property boundaries.

This product has been produced by the Housing and Planning Department for the sole purpose of geographic reference. No warranty is made by the City of Austin regarding specific accuracy or completeness.



City of Austin
Housing and Planning Department
Created on 6/7/2023, by: MeeksS

Future Land Use

	Mixed Use		Single-Family
	Civic		Transportation
	Recreation & Open Space		