

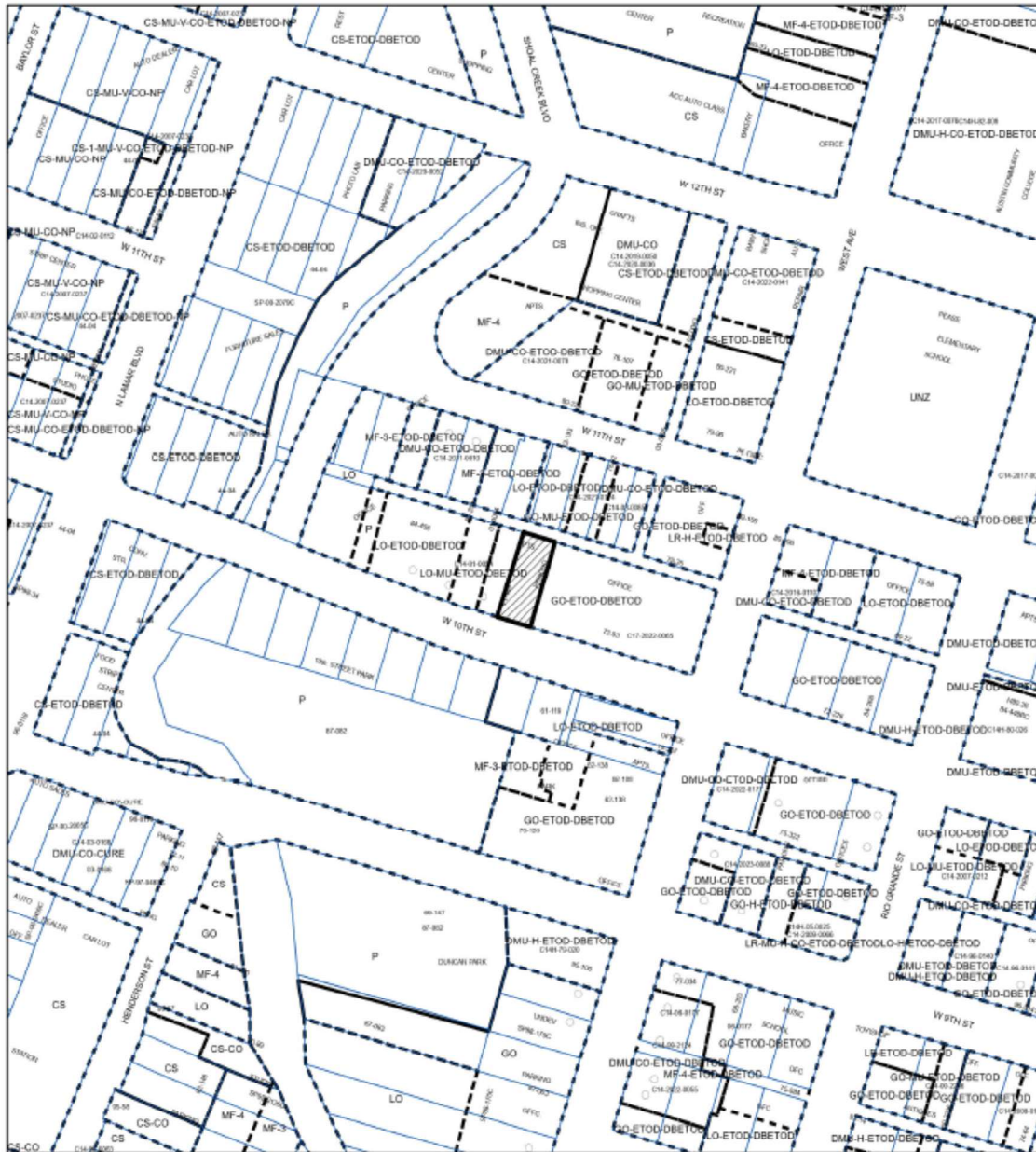

# EXHIBIT "A"

## Location Map



- SUBJECT TRACT
- PENDING CASE
- ZONING BOUNDARY

### HISTORIC ZONING

ZONING CASE#: C14H-1987-0016

1:2,400

This product is for informational purposes and may not have been prepared for or be suitable for legal, engineering, or surveying purposes. It does not represent an on-the-ground survey and represents only the approximate relative location of property boundaries.

This product has been produced by the Planning Department for the sole purpose of geographic reference. No warranty is made by the City of Austin regarding specific accuracy or completeness.

