



# TxDOT Austin District Updates

Tommy Abrego, PE | Mobility35 Program Manager

Christiana Astarita, PE | Oak Hill Parkway & I-35 CapEx Central Project Manager



May 2026

## I-35 Capital Express Central Project - Overview

- **Limits:** US 290 East to SH 71/Ben White Boulevard
- **Length:** 8 miles
- **Project details:**
  - Construct two non-tolled managed lanes in each direction.
  - Reconstruct ramps, bridges and intersections.
  - Improve frontage roads.
  - Enhance bicycle and pedestrian paths.
  - Accommodate transit routes.
- **Estimated construction cost:** \$4.5 billion
- **Construction start:** Late 2024

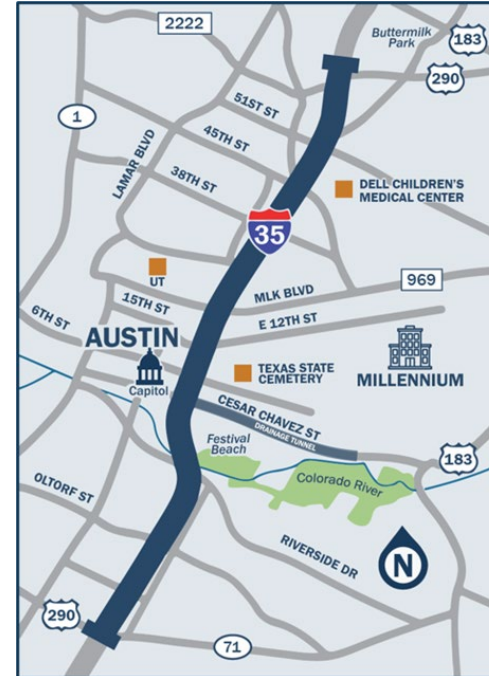



Connecting you with Texas.

# I-35 CAPITAL EXPRESS CENTRAL PROJECT PHASING

## DOWNTOWN (MLK BLVD. TO HOLLY ST.)

**DRAINAGE TUNNEL AND PUMP STATION**  
(UNDER I-35 AND CESAR CHAVEZ ST.)

2025 - 2029

- Reconstruct east-west crossings at Cesar Chavez St., 4th St., 6th St., 7th St., 8th St., 11th St. and 12th St.
- Construct boulevard-style frontage road.
- Construct northbound I-35 frontage road from Lambie St. to Flores St.
- Construct bicycle and pedestrian paths along the I-35 corridor.

- Lower the mainlanes and add two non-tolled managed lanes in each direction.
- Construct new Holly St. bridge.
- Complete boulevard-style frontage road through downtown.
- Construct remaining bicycle and pedestrian paths along the I-35 corridor.

2026 - 2033

**MLK BRIDGE**

2024 - 2026



**LADY BIRD LAKE**  
(HOLLY ST. TO US 290 E/SH 71)

2025 - 2033

- Reconstruct east-west crossings at 38th 1/2 St., 32nd St., and Manor Rd.
- Widen bridges at US 290 and I-35 to accommodate pedestrian paths.
- Construct pedestrian-only bridges at Capital Plaza, 21st St., and the CapMetro Red Line rail bridge at Airport Blvd.
- Construct bicycle and pedestrian paths along the corridor and US 290 East.

## UNIVERSITY (US290 E TO MLK BLVD.)

- Add two non-tolled managed lanes in each direction.
- Remove upper decks and lower I-35 mainlanes.
- Reconstruct east-west crossings at 41st St., Airport Blvd., and Dean Keeton St.
- Construct U-turn bridge at 51st St.
- Complete CapMetro Red Line rail bridge at Airport Blvd.
- Construct boulevard-style frontage road.
- Construct bicycle and pedestrian paths along the corridor.

2026 - 2033

(TENTATIVE, AS OF FEB. 24, 2026)



## Martin Luther King Jr. Blvd Bridge Segment

- **Limits:** at Martin Luther King Jr. Boulevard Bridge
- **Estimated construction cost:** \$34.4 million
- **Construction start:** November 2024
- **Anticipated completion:** Late 2026
- **Anticipated construction impacts (subject to change):**
  - **2026**
    - MLK bridge demolition: NB/SB I-35 mainlanes closure for south side of bridge.
    - EB/WB sidewalk closures.
    - EB/WB lanes reduced.





Connecting you with Texas.

# Martin Luther King Jr. Boulevard Bridge - Demolition





Connecting you with Texas.

# Martin Luther King Jr. Boulevard Bridge - After





Connecting you with Texas.

# Lady Bird Lake Segment

- **Limits:** Holly Street to SH 71/Ben White Boulevard
- **Estimated construction cost:** \$747 million
- **Construction start:** February 2025
- **Anticipated completion:** 2033
- **Anticipated construction impacts (subject to change):**
  - **2026**
    - Phased closures of NB I-35 ramps.
    - Permanent closure of Woodland Avenue at I-35; temporary U-turns added.
    - NB/SB I-35 frontage roads closed at Riverside Drive: Bypass lanes open.
    - Lady Bird Lake: Construction of east pedestrian bridge and phased reconstruction of NB I-35 frontage road.
    - Phased demolition and reconstruction: Riverside Drive intersection.
  - **2028**
    - Lady Bird Lake: Phased demolition and reconstruction of NB/SB I-35 mainlanes.
  - **2029**
    - Phased closures of SB I-35 ramps.
    - Construction of temporary pedestrian bridge at Woodland Avenue; closure of temporary U-turns.
  - **2031**
    - Lady Bird Lake: Phased reconstruction of SB I-35 frontage road; construction of west pedestrian bridge.
    - Construction of SB to NB I-35 elevated Holly U-turn.
    - Construction of elevated managed lanes south of Woodland Avenue.
  - **2032**
    - Lower NB/SB I-35 mainlanes.





*Connecting you with Texas.*

## Riverside Drive – Now





*Connecting you with Texas.*

## Riverside Drive – After





Connecting you with Texas.

## Lady Bird Lake Bridge- Now





*Connecting you with Texas.*

## Lady Bird Lake Bridge- After





Connecting you with Texas.

## Downtown Segment

- **Limits:** Martin Luther King Jr. Boulevard to Holly Street
- **Estimated construction cost:** \$1.63 billion
- **Anticipated construction start:** 2027
- **Anticipated construction completion:** 2033
- **Anticipated construction impacts (subject to change):**



- |   |   |   |   |  |
|---|---|---|---|--|
| <ul style="list-style-type: none"> <li>- <b>2027</b> <ul style="list-style-type: none"> <li>▪ Permanent closure of parking under I-35: 6th St to 8th St.</li> <li>▪ Long-term closure of SB I-35 frontage road: 5th St to Cesar Chavez St.</li> <li>▪ Start of City street closures for utility work during project lifecycle.</li> </ul> </li> </ul> | <ul style="list-style-type: none"> <li>- <b>2028</b> <ul style="list-style-type: none"> <li>▪ Closure of CapMetro RR Station.</li> <li>▪ Long-term closure of cross-street bridges: 11th and 12th St.</li> <li>▪ Construction of temporary pedestrian bridge at 11th St.</li> <li>▪ NB/SB I-35 phased ramp closures.</li> </ul> </li> </ul> | <ul style="list-style-type: none"> <li>- <b>2029</b> <ul style="list-style-type: none"> <li>▪ Reopen CapMetro RR Station.</li> <li>▪ Phased construction of SB I-35 frontage road: 12th St to Cesar Chavez St.</li> </ul> </li> </ul> | <ul style="list-style-type: none"> <li>- <b>2030</b> <ul style="list-style-type: none"> <li>▪ Reopen SB I-35 frontage road from 5th St to Cesar Chavez St.</li> <li>▪ Alternating closures: 5th, 6th St, 7th St, 8th St.</li> <li>▪ Reopen 11th and 12th St bridges.</li> </ul> </li> </ul> | <ul style="list-style-type: none"> <li>- <b>2031</b> <ul style="list-style-type: none"> <li>▪ NB/SB I-35 frontage road traffic switch to boulevard section between 12th St and Cesar Chavez St.</li> </ul> </li> <li>- <b>2032</b> <ul style="list-style-type: none"> <li>▪ Lower NB/SB I-35 mainlanes.</li> </ul> </li> </ul> |
|---|---|---|---|--|



*Connecting you with Texas.*

## 4th Street at I-35 - Now

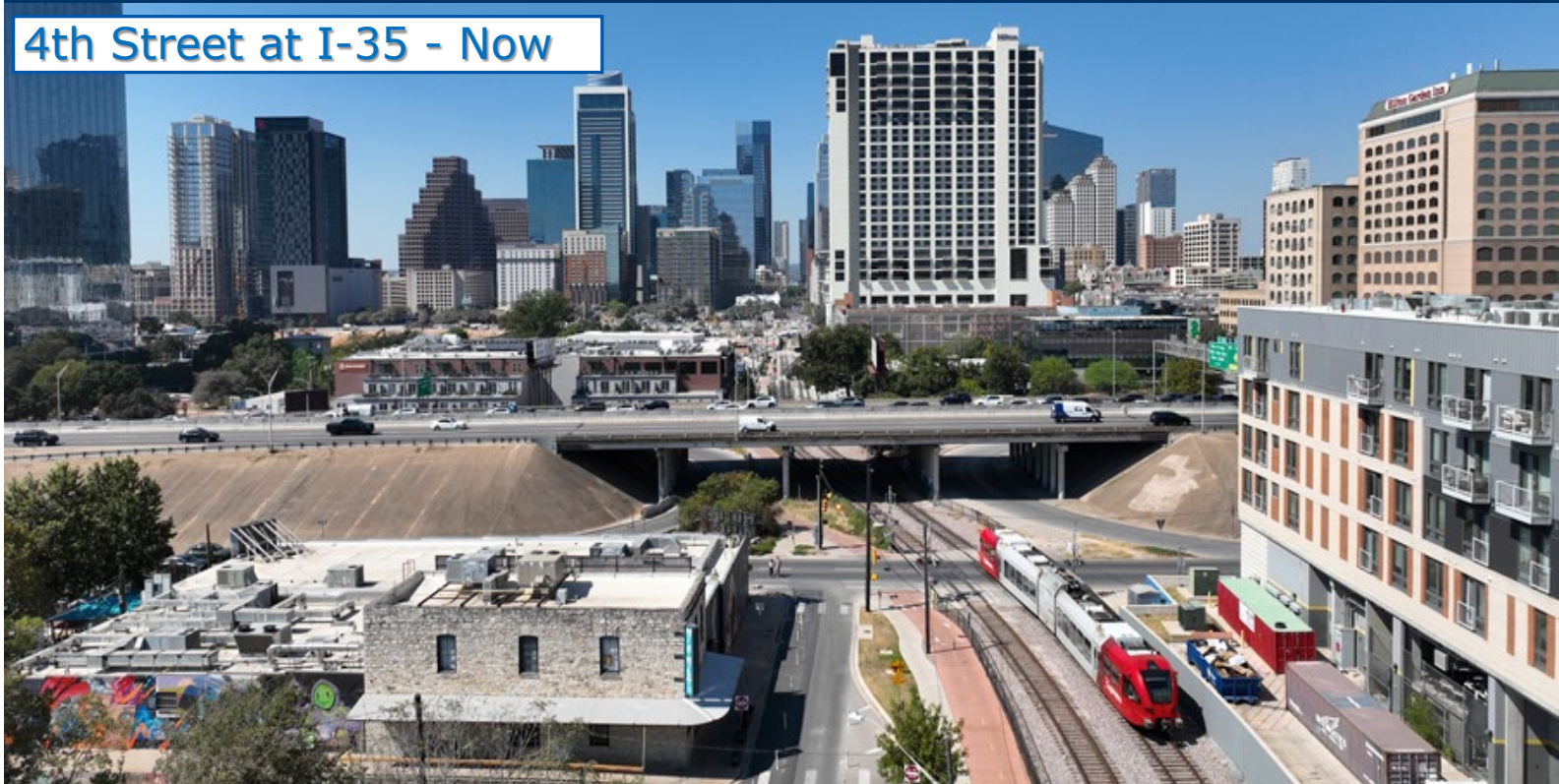



Connecting you with Texas.

# 4th Street at I-35 without caps - After





*Connecting you with Texas.*

## 8th Street at I-35 - Now

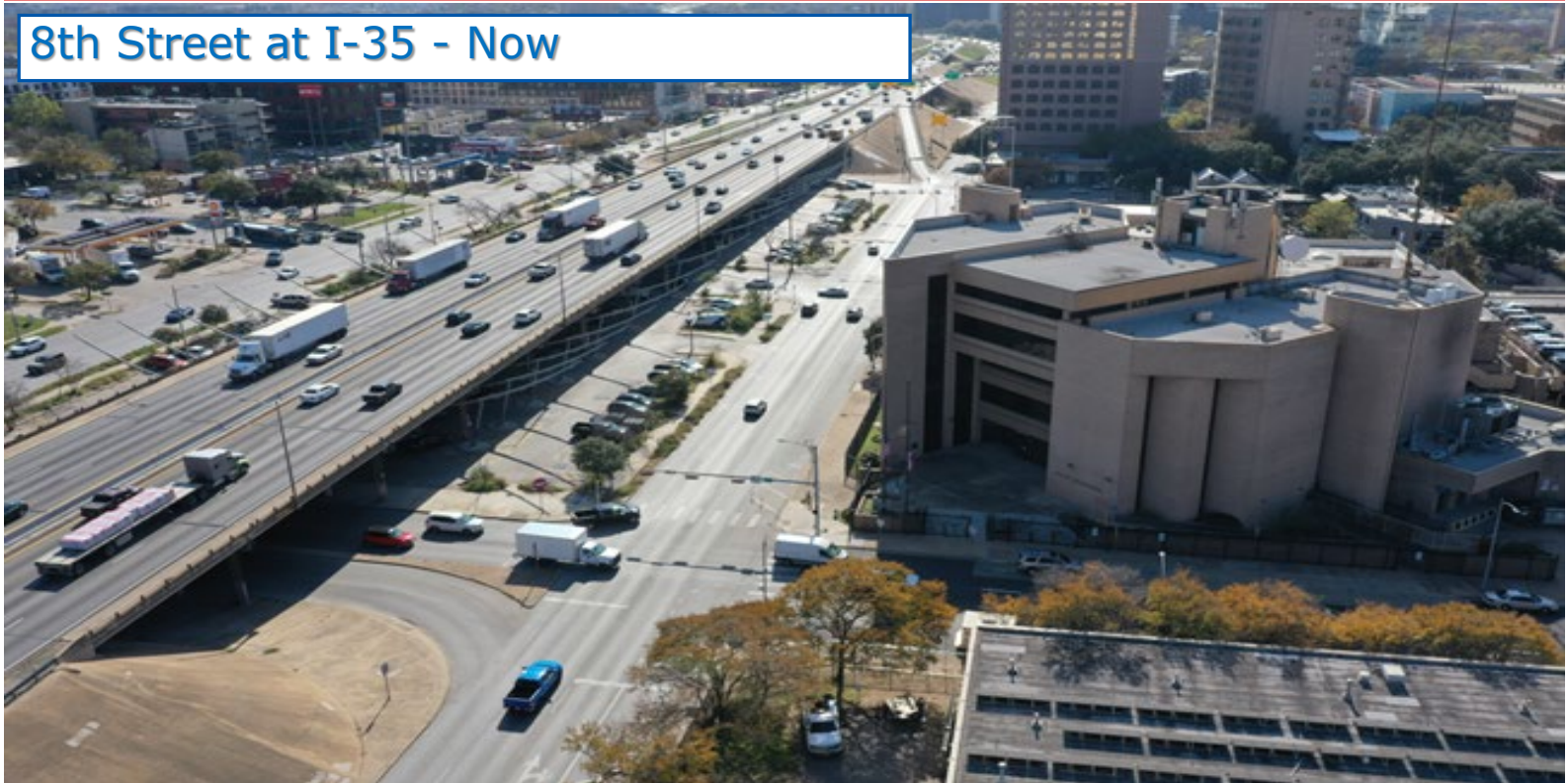

# 8th Street at I-35 without caps - After





Connecting you with Texas.

## 12th and 11th Street bridges - Now





Connecting you with Texas.

# 11th Street bridge - After





Connecting you with Texas.

# University Segment

- **Limits:** US 290 East to Martin Luther King Jr. Boulevard
- **Estimated construction cost:** \$1.48 billion
- **Anticipated construction start:** 2027
- **Anticipated construction completion:** 2033
- **Anticipated construction impacts (subject to change):**



**2027-2028**

- Utility relocations.
- SB I-35 main elevated bridge retrofit.
- NB/SB I-35 frontage road Manor Rd to Wilshire Blvd/41st St and north of Airport Blvd to US 290.
- NB/SB I-35 lower deck at cross streets (Manor, 32nd, 38th 1/2).
- NB/SB I-35 mainlane and ramp construction from 51st St to US 290 E.
- Phased cross-street reconstruction: Manor Rd, 38th 1/2 St, pedestrian bridge at Capital Plaza.

**2029**

- NB/SB I-35 frontage road north of Airport Blvd to US 290 E.
- NB/SB I-35 lower deck construction at 32nd St.
- Reconstruction of 32nd St bridge.
- NB I-35 frontage road closure: Manor Rd to 32nd St.

**2030**

- NB I-35 elevated section demolition and reconstruction.
- SB I-35 traffic elevated only; NB I-35 traffic lower deck only.
- Construction of SB I-35 frontage road: Concordia to Wilshire Blvd.
- Phased cross-street reconstruction: Wilshire Blvd, Dean Keeton St and Airport Blvd.
- CapMetro RR crossing south of Airport Blvd on Shoofly.
- NB I-35 phased opening of depressed ramps.

**2031**

- SB I-35 mainlane reconstruction.
- NB/SB I-35 frontage road realignment: 32nd St to MLK Jr Blvd.
- CapMetro RR crossing permanent bridge open.

**2032**

- SB I-35 elevated section demolition.



*Connecting you with Texas.*

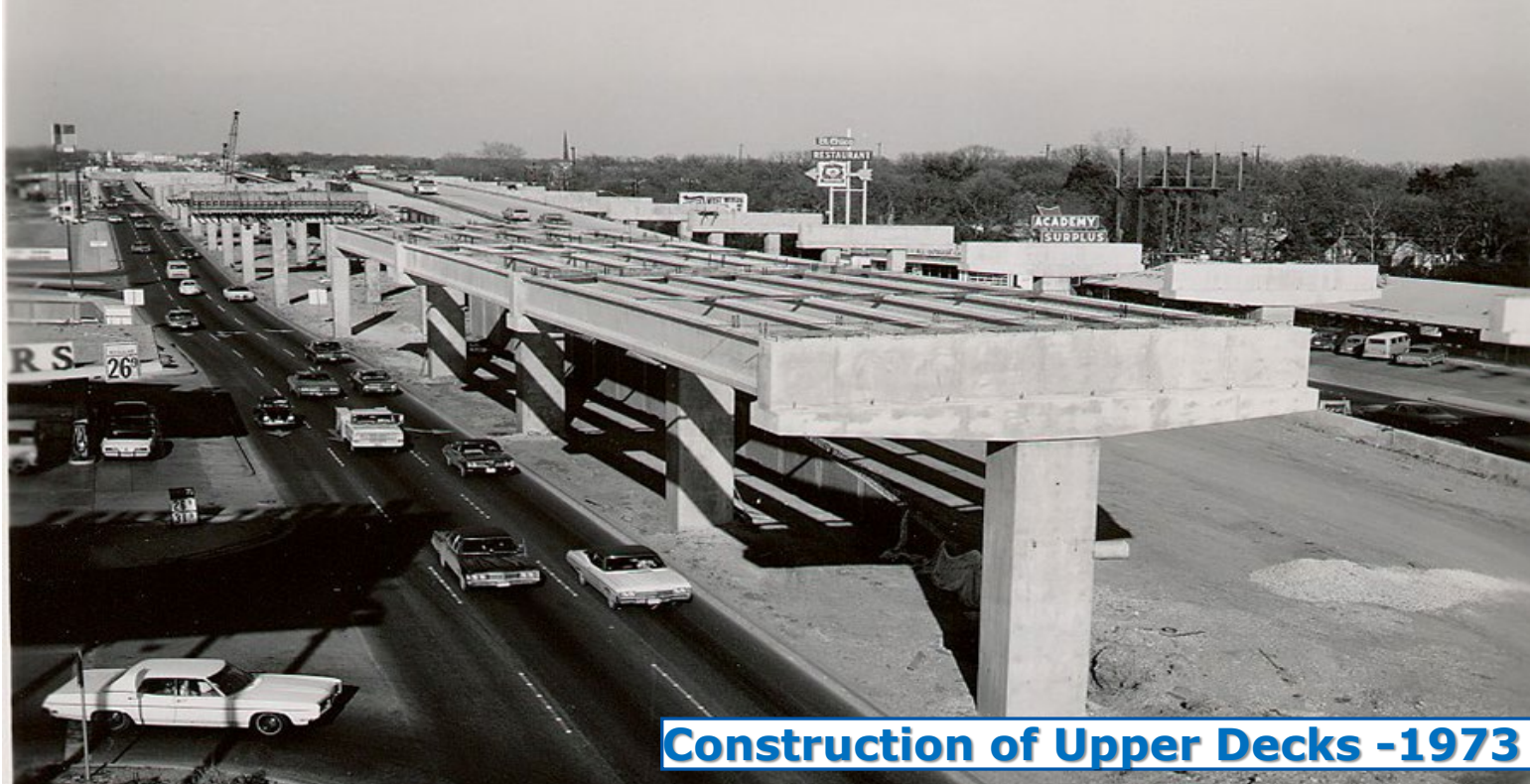

**Construction of Upper Decks - 1973**



Connecting you with Texas.

## I-35 at Edgewood Avenue - Now





Connecting you with Texas.

## I-35 (lowered) at 41st Street - After



## Drainage Tunnel and Pump Station Segment

- **Limits:** Airport Boulevard to Holly Street; Cesar Chavez Street to US 183
- **Estimated construction cost:** \$1.1 billion
- **Construction start:** May 2025
- **Anticipated construction completion:** 2029
- **Anticipated tunnel depth:** Ranging 70 feet – 200 feet
- **Anticipated construction impacts (subject to change):**
  - **2026**
    - TBM arrives in mid-2026, begins underground at Airport Blvd and Cesar Chavez St/US 183.
    - All nine drop shaft sites underway with sound walls and shaft access construction.
    - SB I-35 frontage road closure from East Ave to River St.
    - Brushy St and Cesar Chavez St pedestrian sidewalk closure at I-35.
    - I-35 frontage road lane reductions at 11th St.
    - Levander Loop trail closure at US 183.

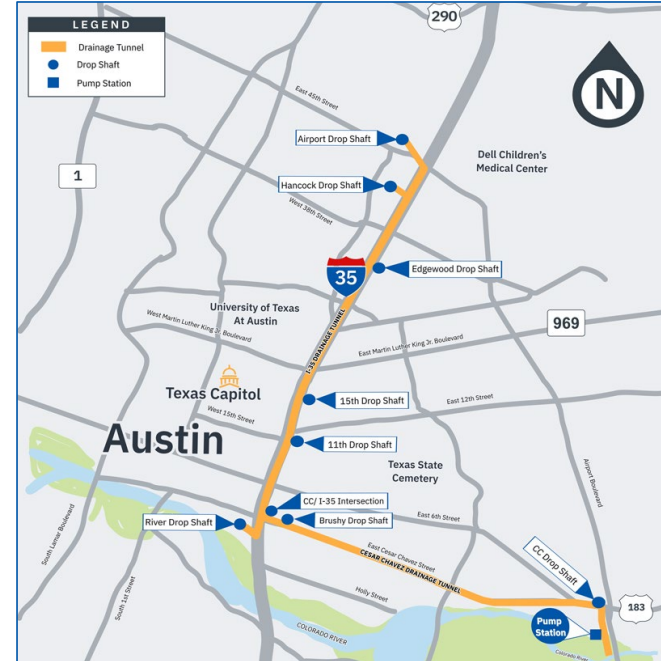



Connecting you with Texas.

# Airport Boulevard at I-35 Drop Shaft



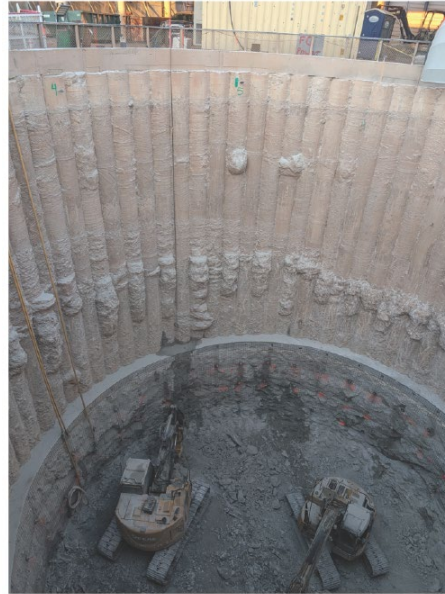



*Connecting you with Texas.*

## US 183 at Cesar Chavez Pump Station





*Connecting you with Texas.*

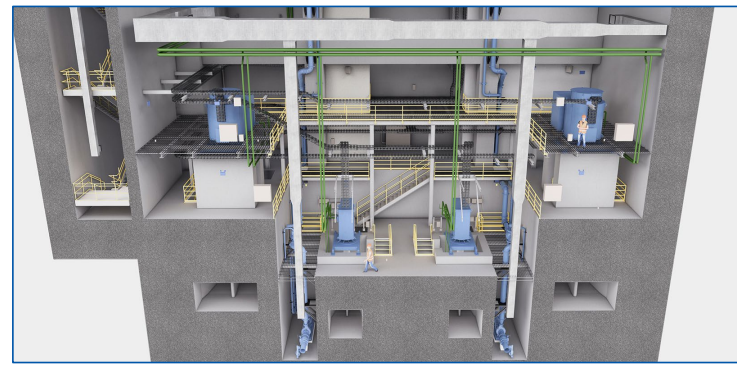
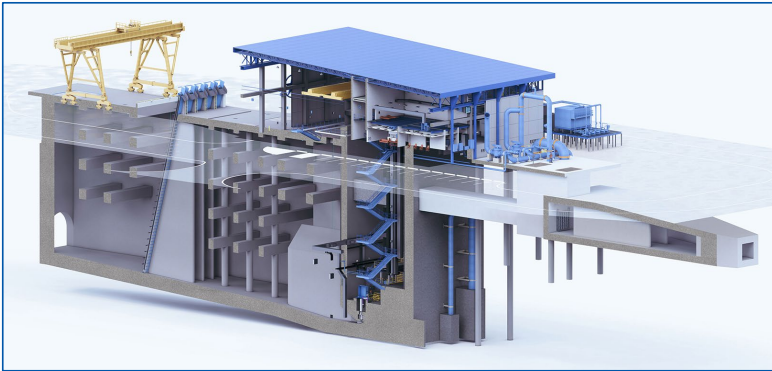
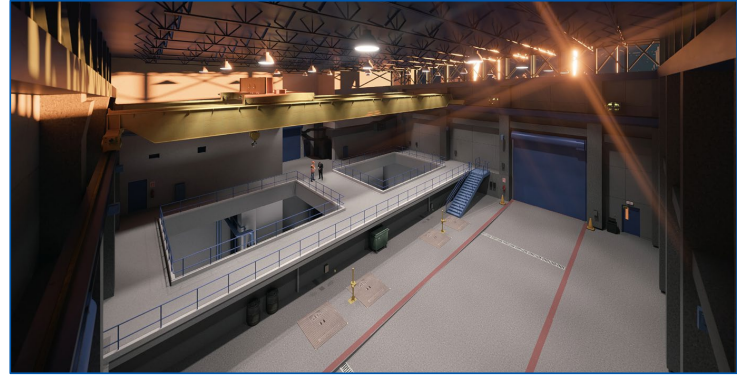

## I-35 CapEx South and North Projects – Under Construction

### CapEx South

- SH 71/Ben White Blvd to SH 45 SE (8 miles).
- 2 managed lanes each direction.
- 2 miles of intersection bypass lanes.
- Shared-use path.
- \$548 million.
- Construction start – 2022.
- Anticipated completion – 2028.

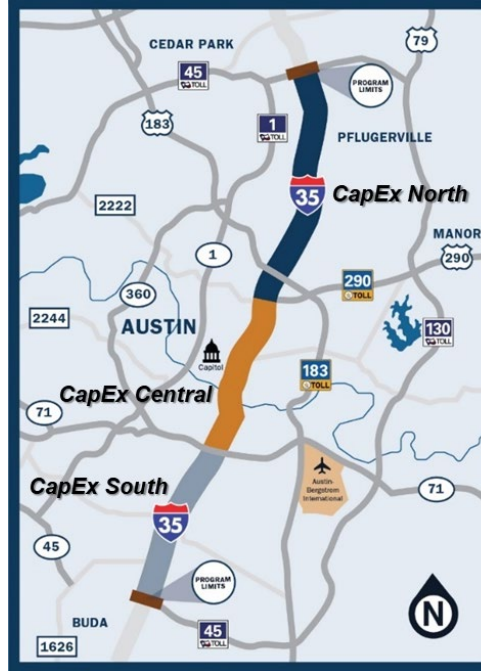

### CapEx North

- SH 45 North to US 290 East (11.5 miles).
- 1 managed lane each direction.
- Reconstructing bridges and interchanges.
- 5 miles of shared-use path.
- \$606 million.
- Construction start – 2023.
- Anticipated completion – 2029.



Connecting you with Texas.

## CPP Overview



35+ significant construction projects that are soon-to-be under way in Central Texas, representing more than \$20B in infrastructure investment from federal, state and local funding sources. The region's transportation agencies have come together to form the Central Texas Construction Partnership Program (CPP) to:

- **Prioritize public safety**
- **Reduce community impacts when possible**
- **Maintain mobility and accessibility where feasible**
- **Keep the public informed and speak with one voice**
- **Manage surprises and conflicts**

A COMPANION APP TO  
TRADITIONAL JOURNEY  
PLANNING TOOLS





Connecting you with Texas.



CTXGO App Store



CTXGO Google Play Store



CTXGO Website



CTXGO YouTube Video



*Connecting you with Texas.*

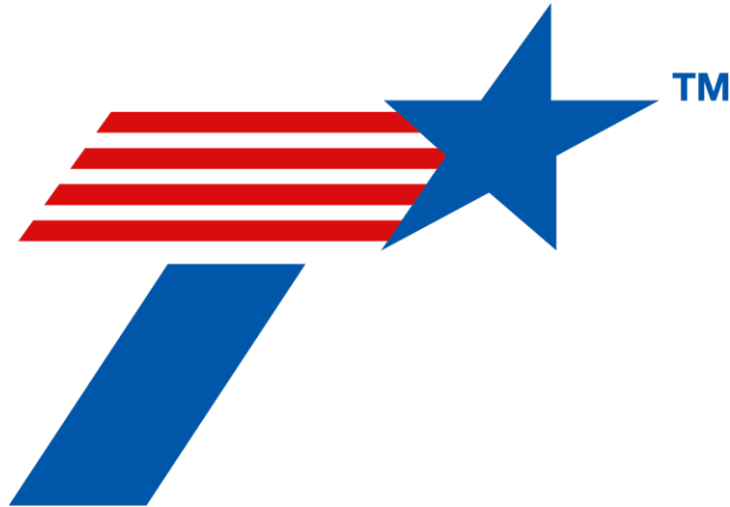

[www.mymobility35.com](http://www.mymobility35.com)