

Mayor

APPROVED: _____ **ATTEST:** _____
Deborah Thomas Erika Brady
City Attorney City Clerk

DRAFT

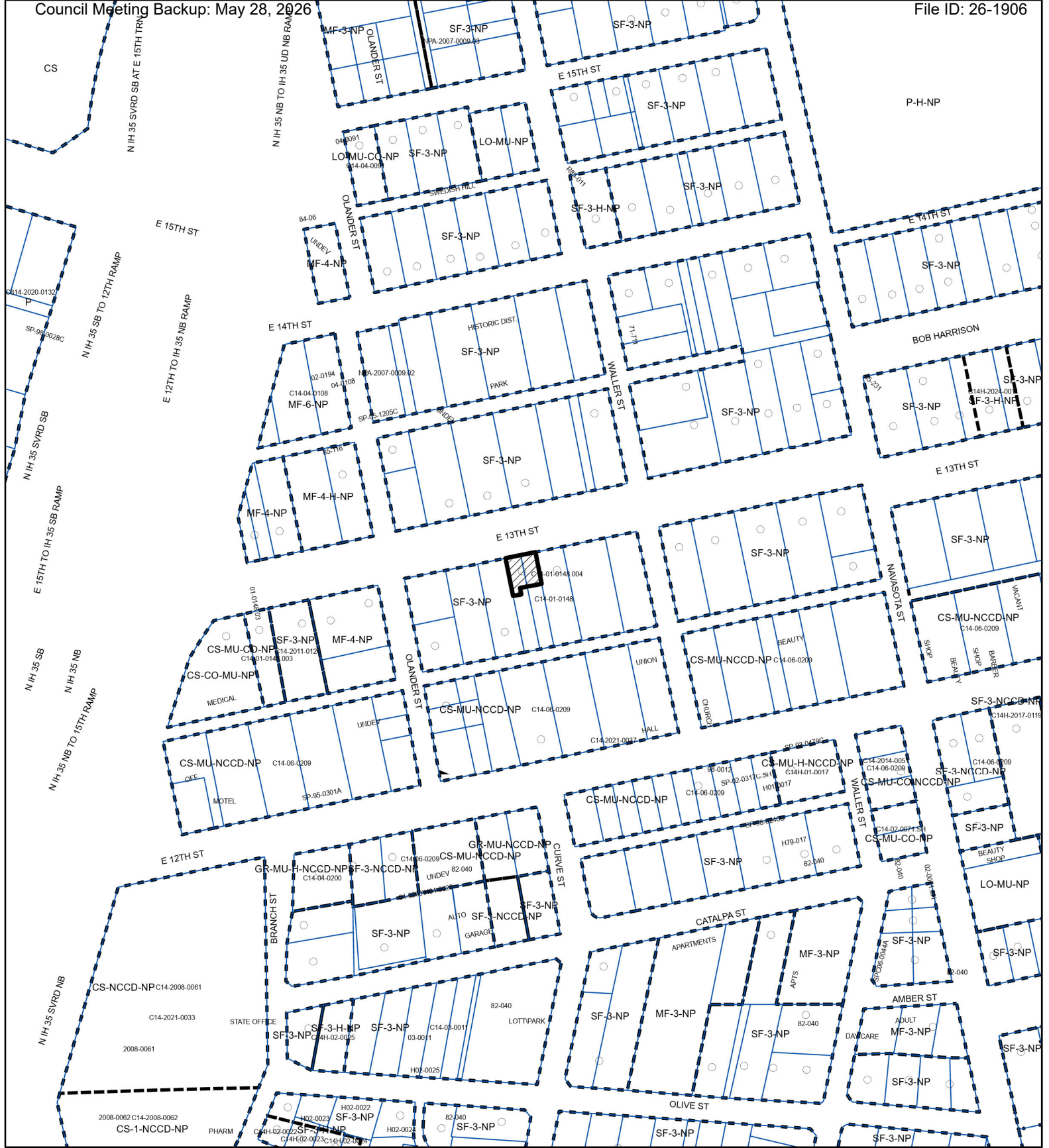



36
37
38
39
40
41



HISTORIC ZONING

ZONING CASE#: C14H-2026-0013

EXHIBIT "A"

-  N
-  SUBJECT TRACT
-  PENDING CASE
-  ZONING BOUNDARY

1" = 200'

This product is for informational purposes and may not have been prepared for or be suitable for legal, engineering, or surveying purposes. It does not represent an on-the-ground survey and represents only the approximate relative location of property boundaries.

This product has been produced by Austin Planning for the sole purpose of geographic reference. No warranty is made by the City of Austin regarding specific accuracy or completeness.

